

Power Connectors

Lamp Connectors : LC-3 Series

■ Features

1. This is a high-voltage connector for lamps capable of handling an DC voltage of up to 25kV(peak).
2. This compact connector design is an ideal choice for downsized equipment.

■ Specifications

- Rated Voltage AC/DC : 250V AC/DC, 10A
- Contact Resistance : 20mΩ max.
- Insulation Resistance : 1000MΩ min. at 500V DC
- Withstanding Voltage : 25kV DC (for one minute)
- Operating Temperature Range : -20°C to +150°C



Plug : CCT9402-5801F

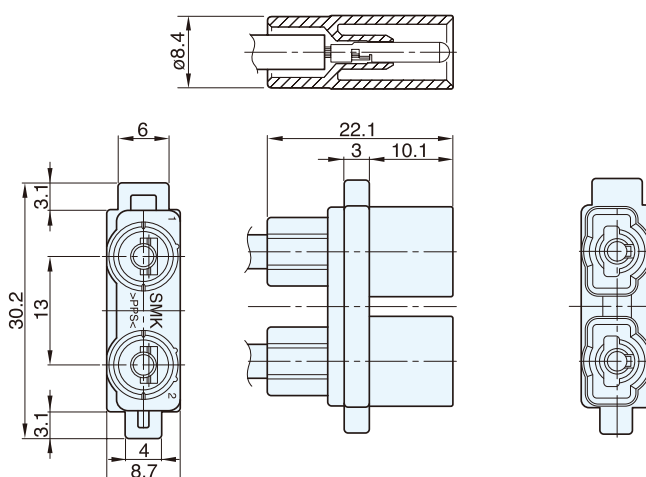

Socket : CCT9402-5901F

