

Power Connectors

Lamp Connectors : LC-4 Series

■ Features

1. This is a middle-voltage connector for lamps capable of handling an DC voltage of up to 15kV(peak).
2. This compact connector design is an ideal choice for downsized equipment.

■ Specifications

- Rated Voltage AC/DC : 250V AC/DC, 7A
- Contact Resistance : 20mΩ max.
- Insulation Resistance : 1000MΩ min. at 500V DC
- Withstanding Voltage : 15kV DC (for one minute)
- Operating Temperature Range : -20℃ to +150℃



Plug : CCT0104-0101F

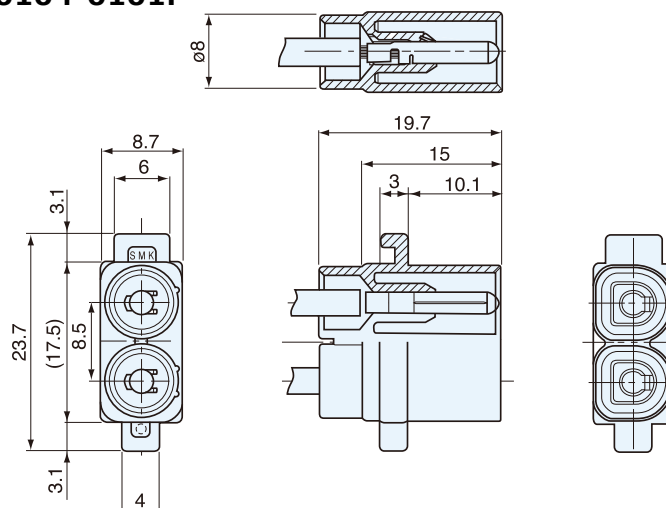

Socket : CCL0504-0101F

